

## Training at PDSVISION

*Training is one of the best investments a company can make; it is not a huge expense, it creates a better quality of work, it creates efficiency and it is fun! PDSVISION is proud to be a Certified Platinum Training Provider of PTC courses.*

*Whether you are a first-time or an experienced user we offer suitable training for your needs. Greater knowledge contributes to increased efficiency and higher quality of work.*

# Sheetmetal Design using Creo Parametric

---

**Course Length:** 2 days

**Prerequisites:** Introduction to Creo Parametric

**Audience:** Users intended to design sheetmetal models in Creo Parametric

## Course Description:

Sheetmetal Design using Creo Parametric is a comprehensive training course that teaches you how to create sheet-metal parts in Creo Parametric. The course builds upon the basic lessons you learned in Introduction to Creo Parametric and serves as the second stage of learning. In this course, you will learn how to design sheetmetal parts and assemblies, including sheet-metal production drawings. All the functions needed to create sheet-metal parts, drawings, and assemblies are covered. Upon completion of this course, you will be able to create sheet-metal design models, create the flat state of the model, and document both in production drawings.

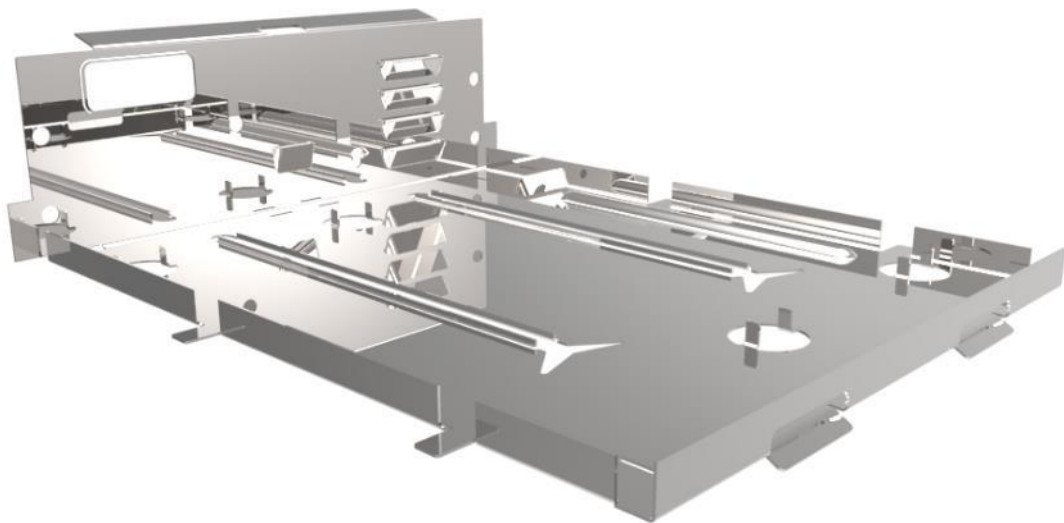

## Course Content:

The course is divided into 9 modules covering the most common features and functions of sheet-metal design. Each day a certain amount of modules are presented and exercises based on information in the modules are performed. The last module is a design project where the acquired knowledge regarding sheetmetal design is used.

### Day 1

- Module 1 - Introduction to the Creo Parametric Sheetmetal Design Process
- Module 2 - Sheetmetal Model Fundamentals
- Module 3 - Creating Primary Sheetmetal Features
- Module 4 - Creating Secondary Sheetmetal Wall Features

### Day 2

- Module 5 - Bending and Unbending Sheet-metal Models
- Module 6 - Modifying Sheet-metal Models
- Module 7 - Sheet-metal Setup and Tools
- Module 8 - Detailing Sheet-metal Designs
- Module 9 - Design Project